

WACT Spring Meeting 2026

Rooks Hill Project
April update

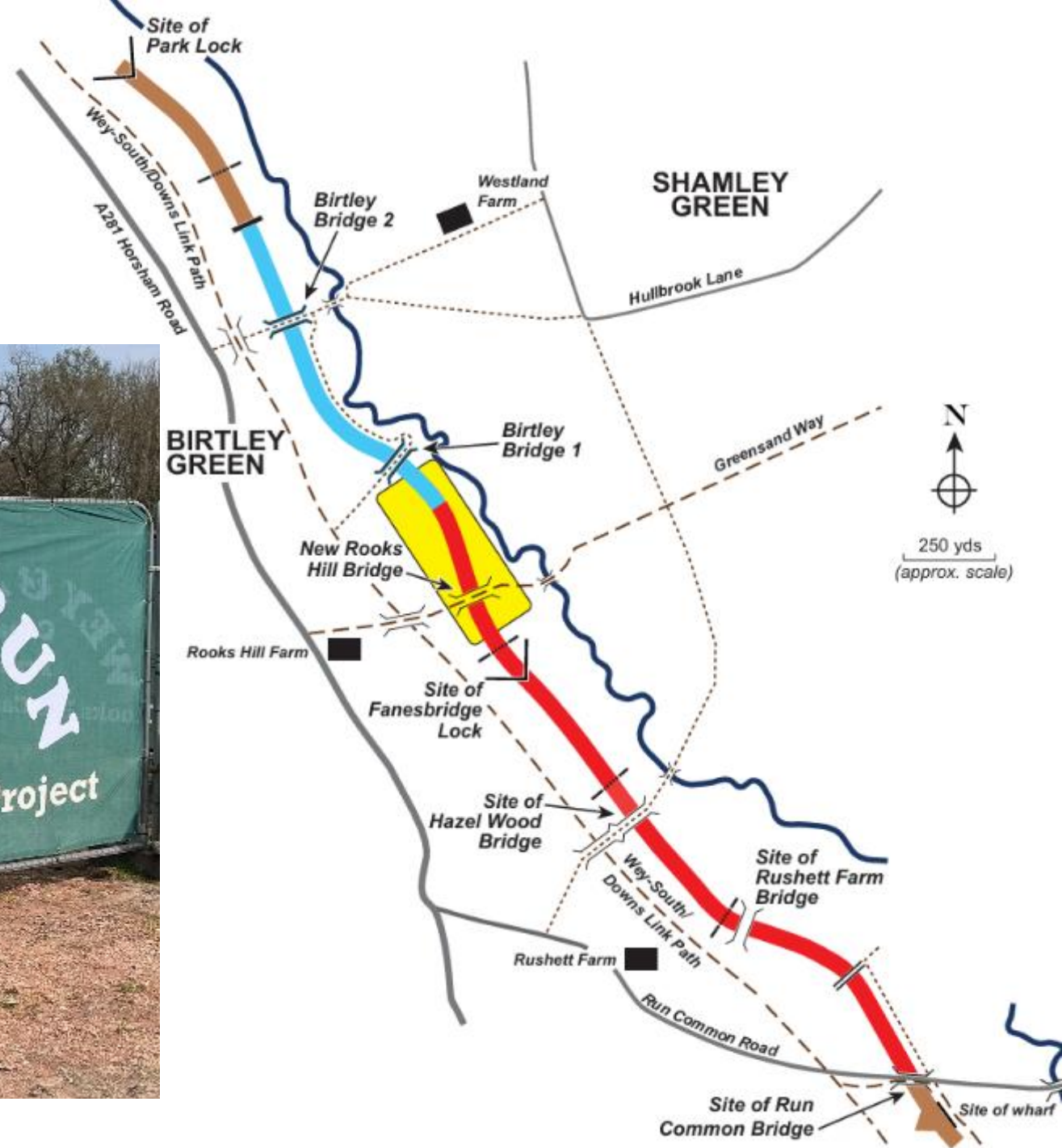

Background

- 900 metres of canal and footpath at Birtley restored 2018 - 2023
- Two new lifting bridges installed
- Circular footpath route with Downs Link established and well used
- Water supply from springs at the northern end

Rooks Hill

- One of the Trust's priority areas
- Extends useable canal south from Birtley
- Includes first new length of canal since WACT formed
- Phased project - Phase 1 nearing completion



Three phases

Phase 1:

- Bridleway brick faced concrete overbridge and approach ramps
- 100m of waterway bank retaining wall
- Overflow weir
- West bank - Bridge to Fanesbridge boundary
- Repair Fanesbridge culvert

Phase 1 Timetable

- **April/May** Site set up, access planning conditions
- **June** Dig out bridge hole and cast base
- **July** WRG summer camps
- **Aug 25 - June 2026** Complete bridge, waterway wall & banks, culvert/weir and towpath to Fanesbridge boundary

The Bridge

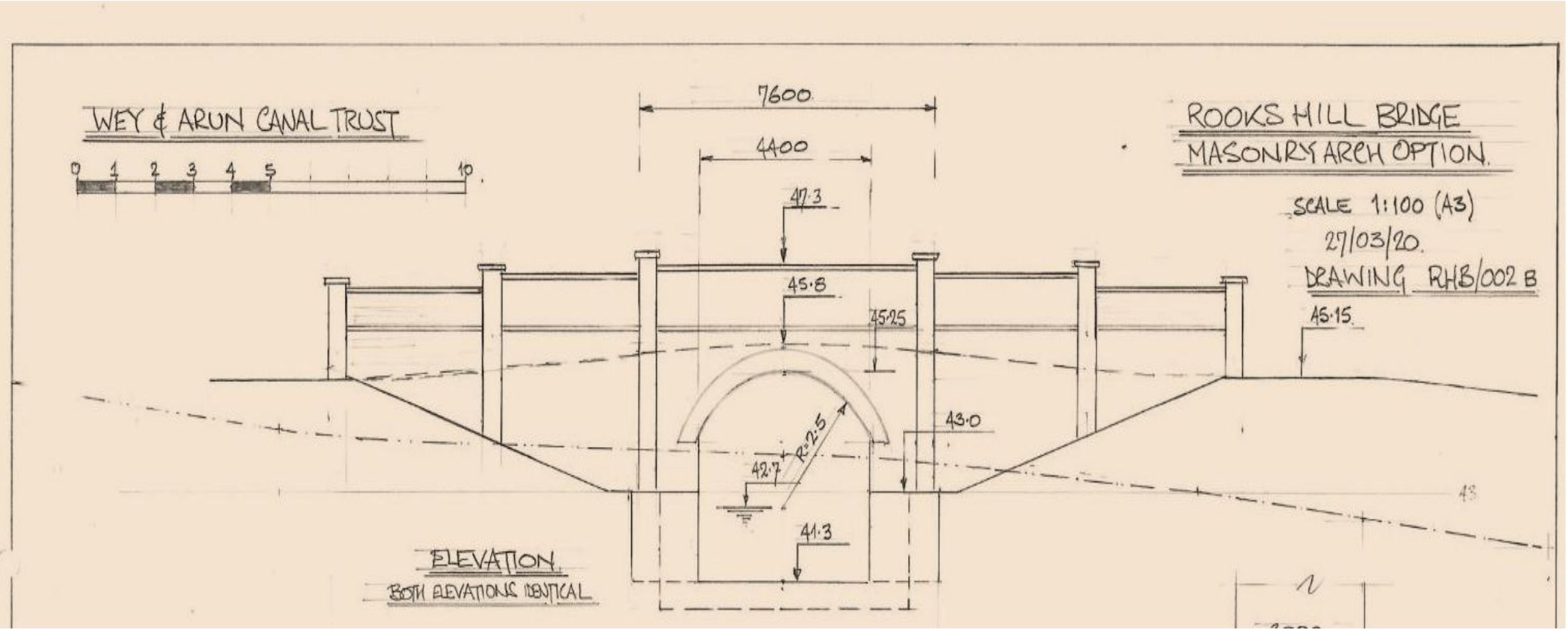















































The waterway bank retaining wall and overflow weir

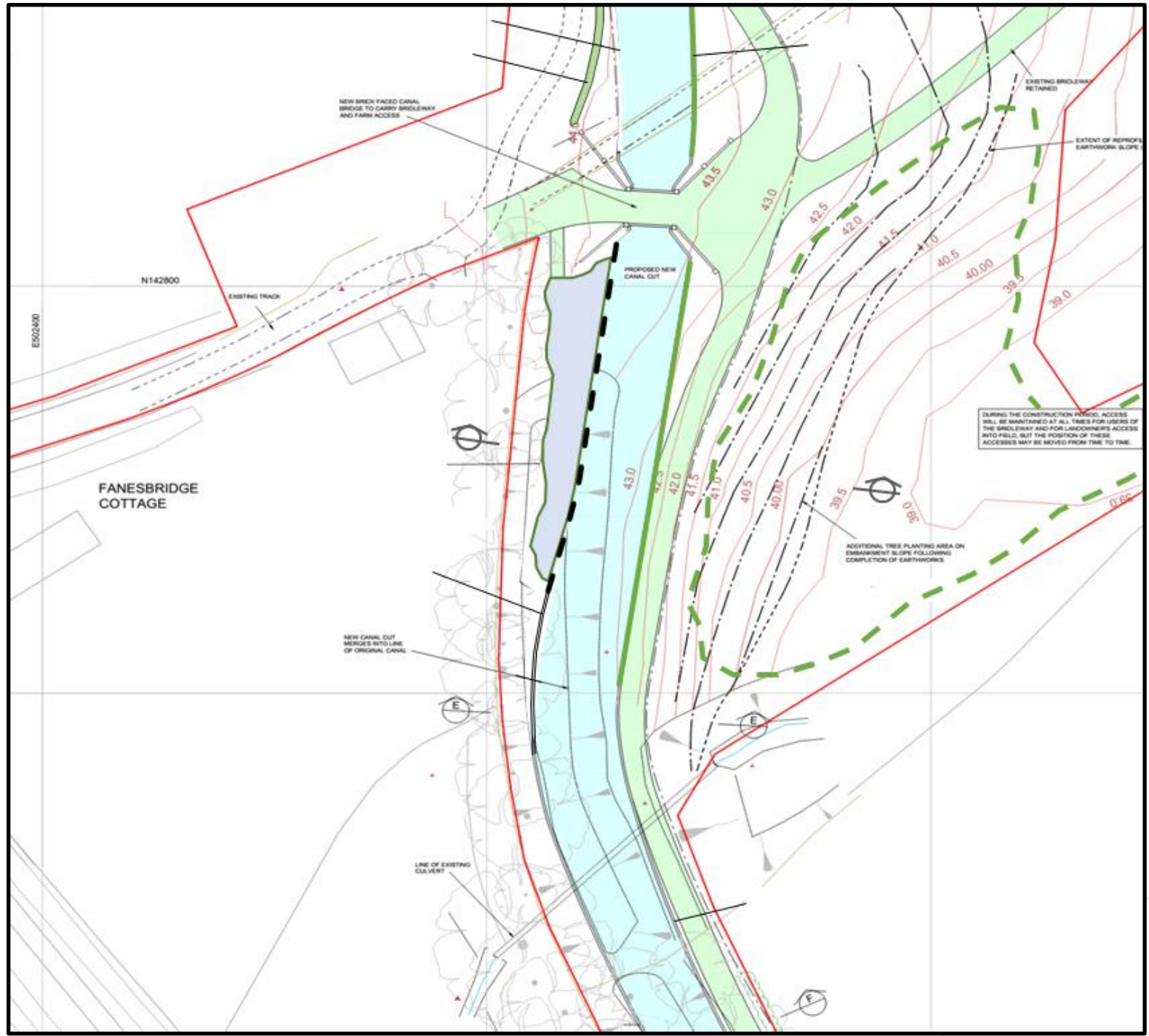

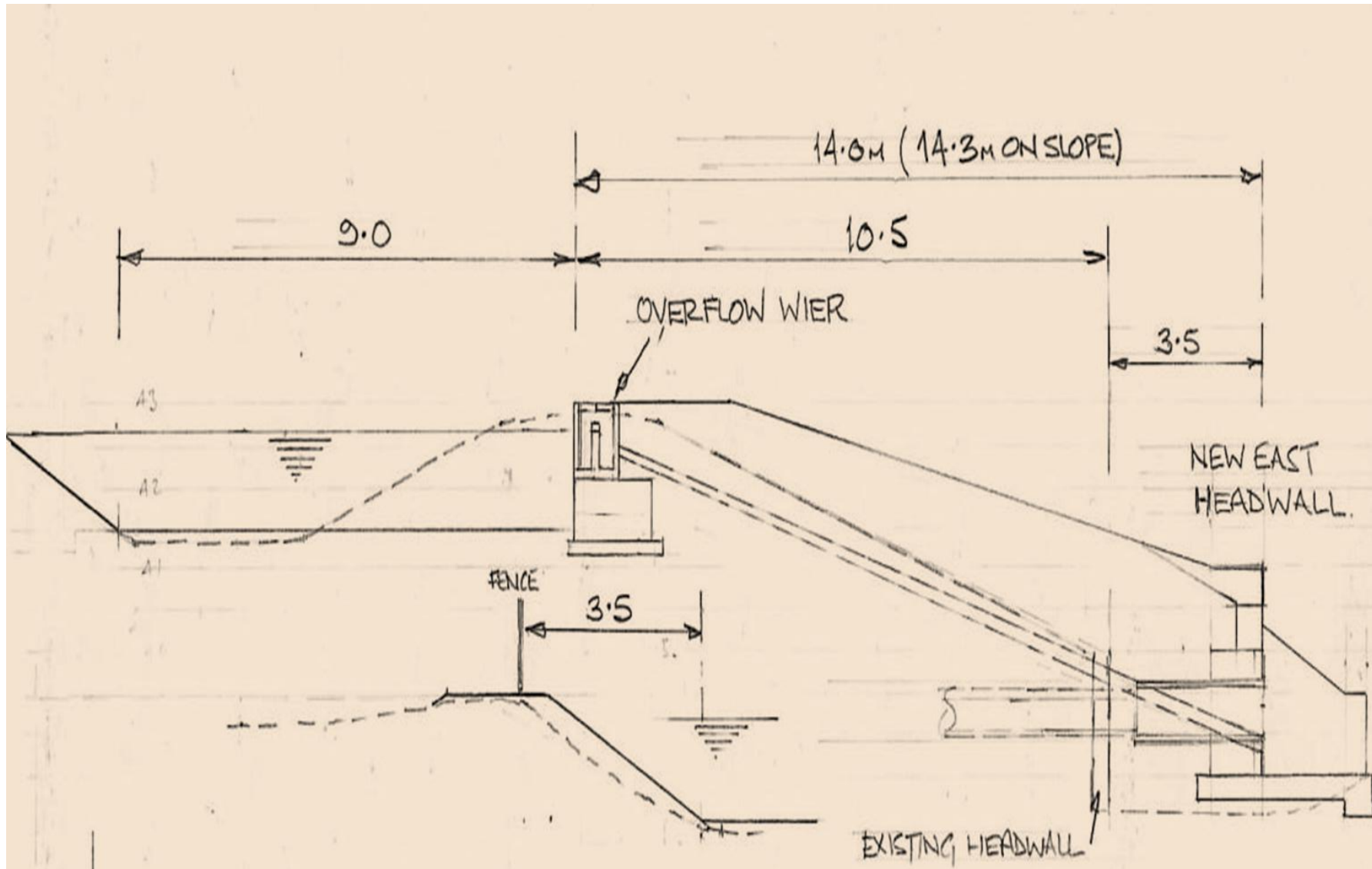

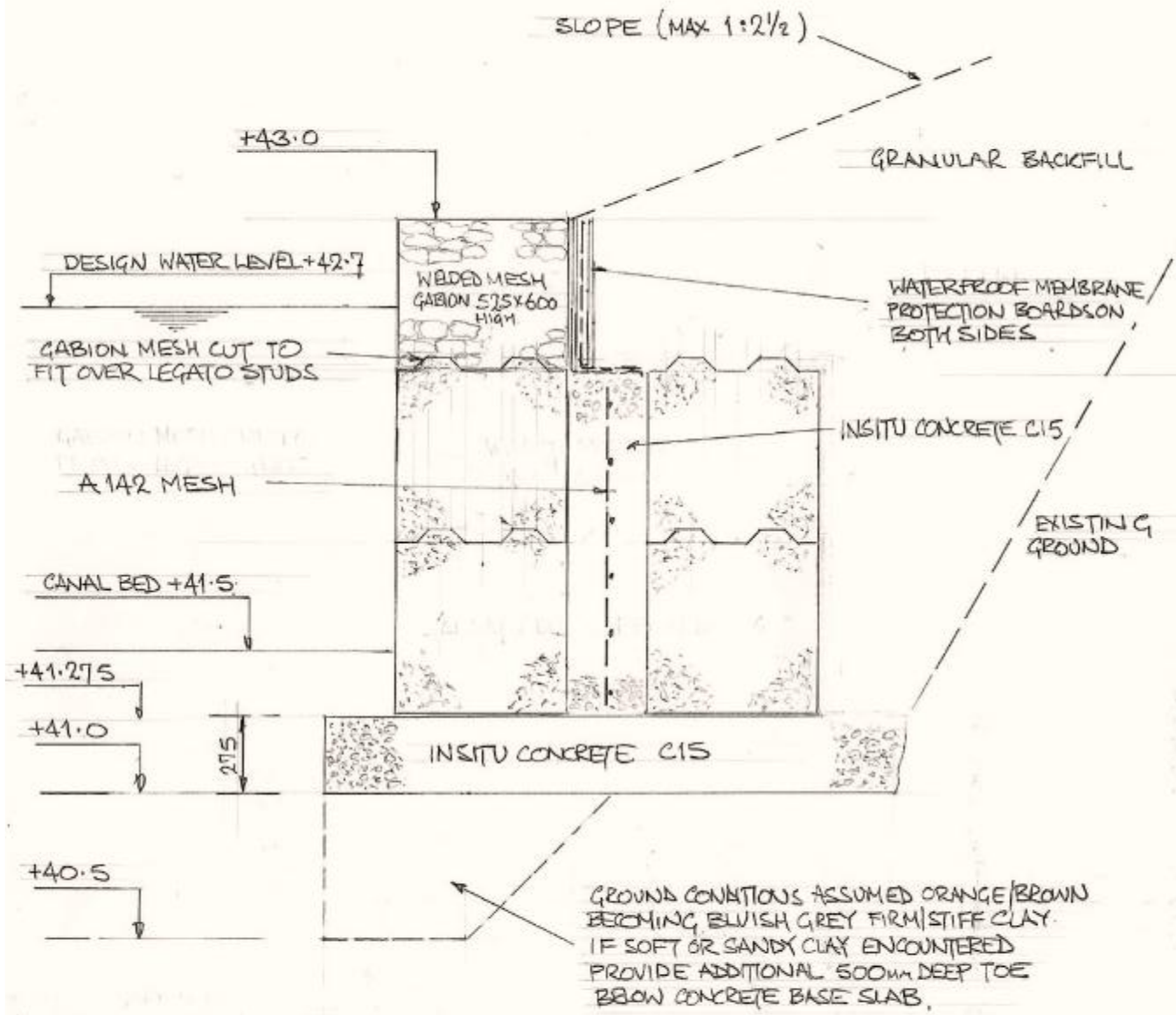

TYPICAL ELEVATION

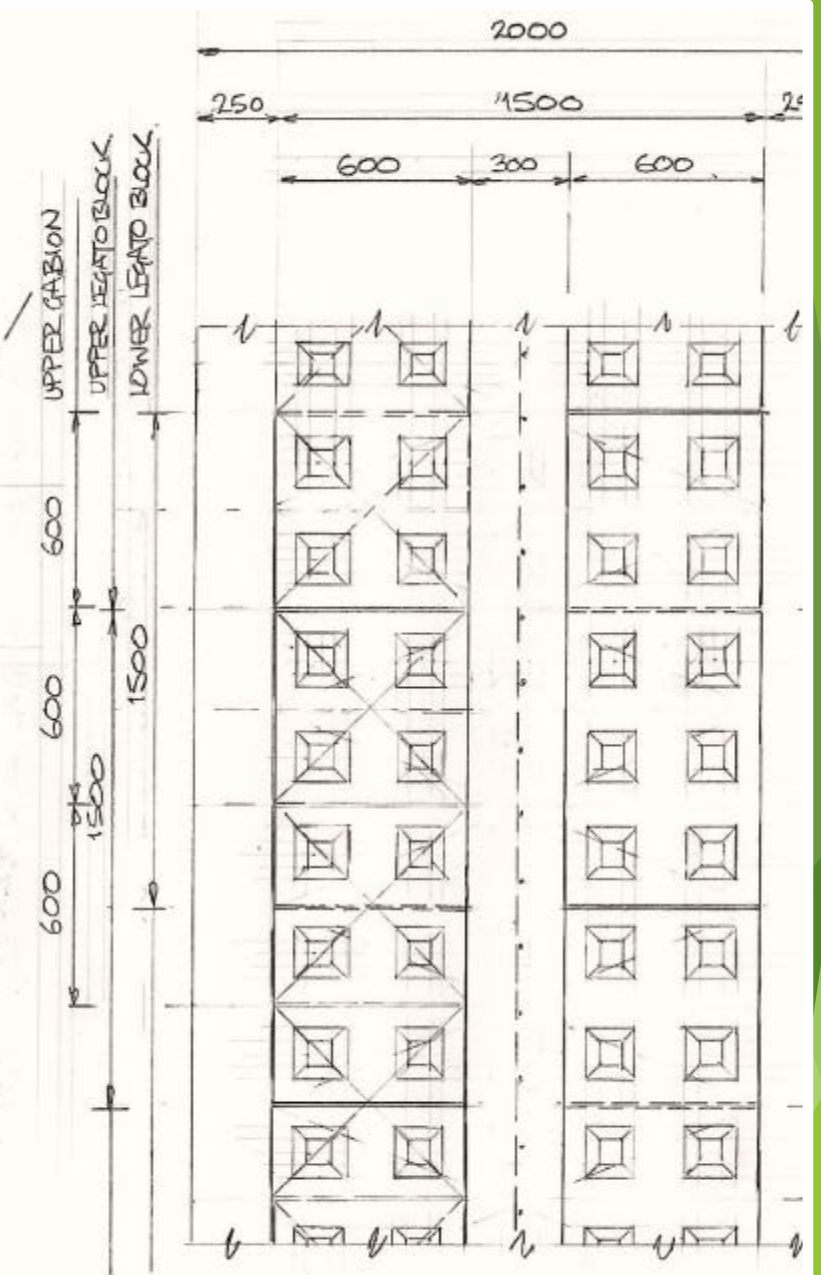

TYPICAL PLAN

















The Culvert



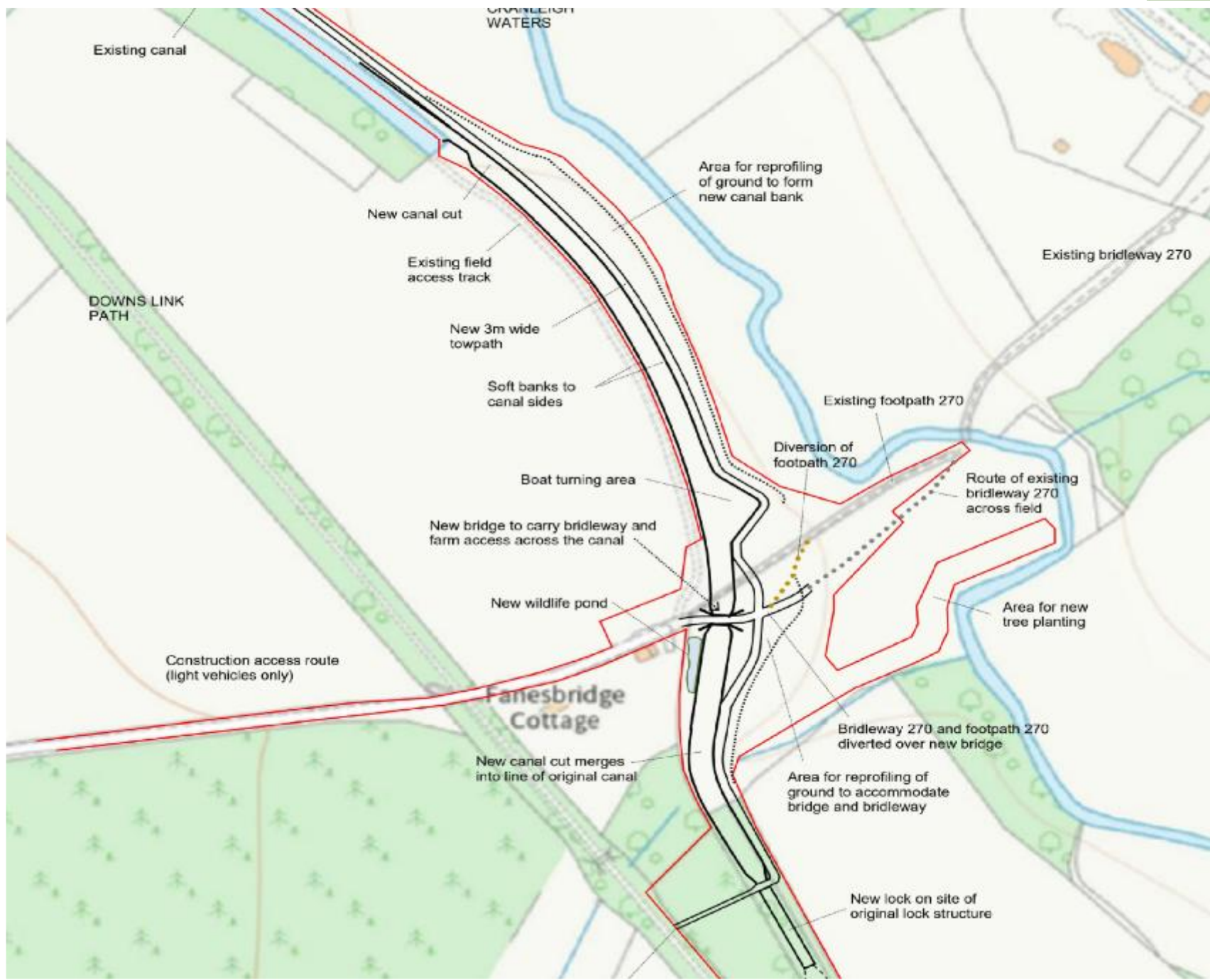









The West Bank waterway wall







Phase 2 - 2026/2027

- 300 metres of newly dug canal north from bridge
- Soft banks with coir rolls on gabions planted to enhance ecology
- Narrows section to link to existing canal
- New hedge and tree planting
- 3 metre wide permissive footpath from Birtley to the Greensand Way

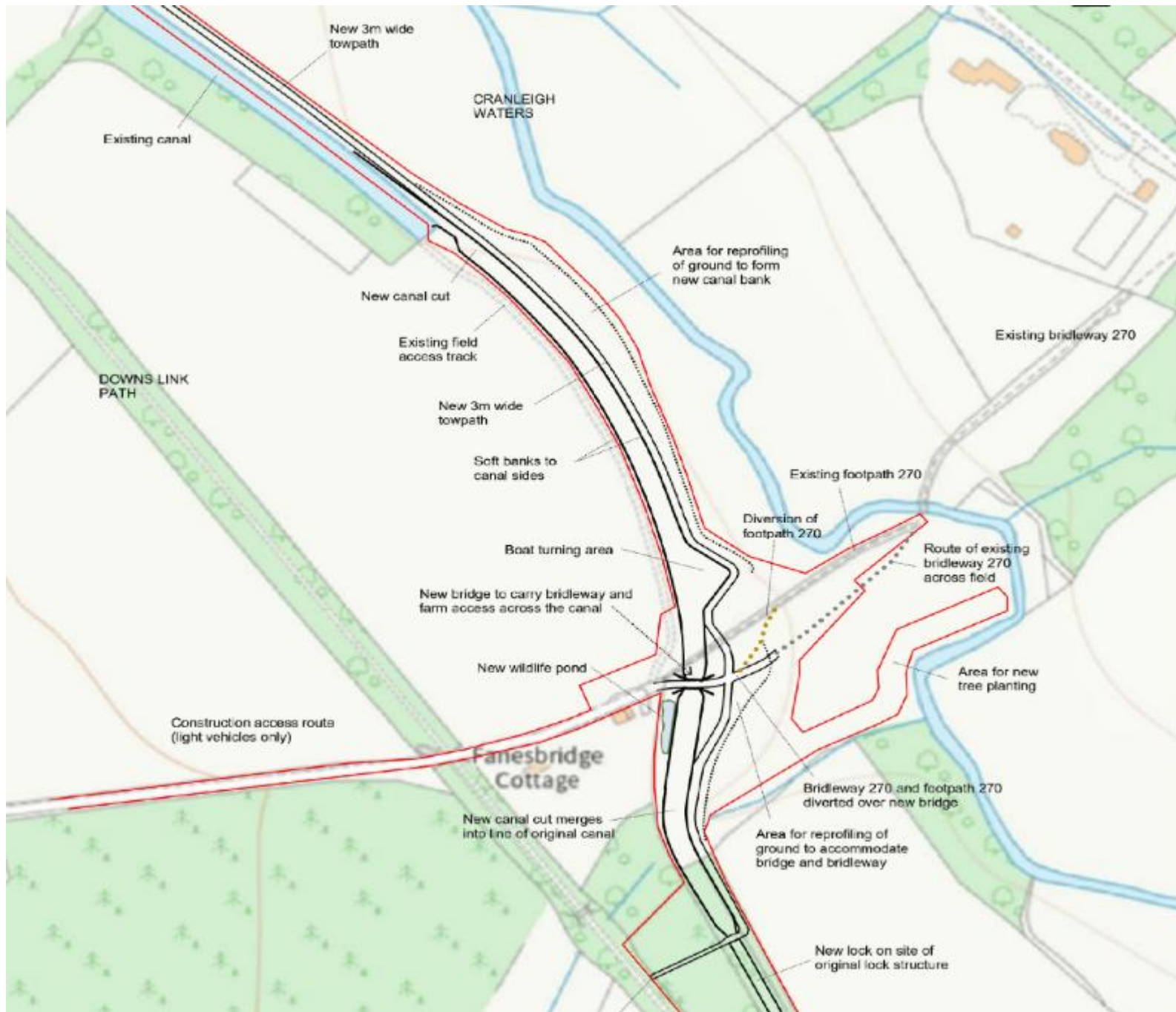

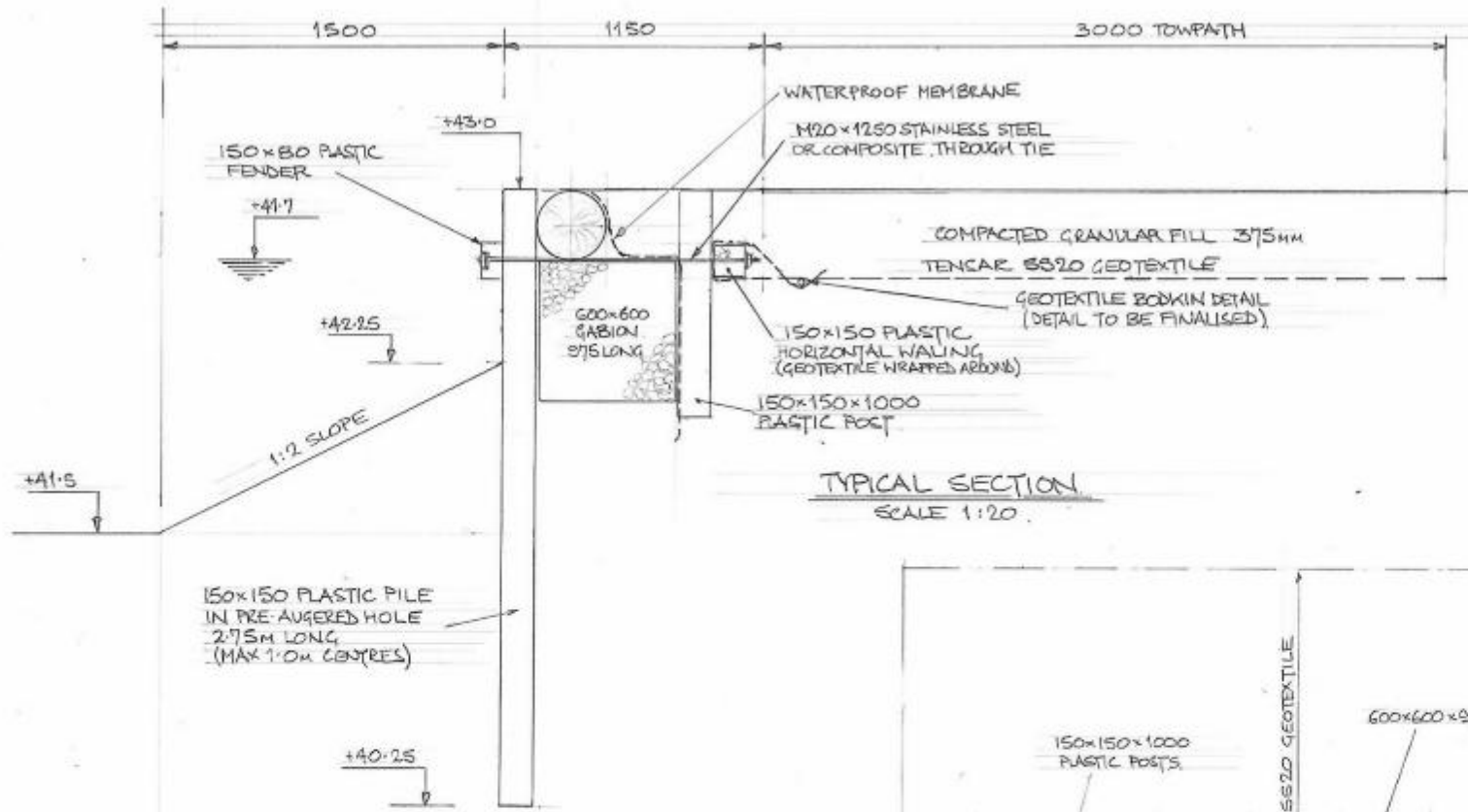

TYPICAL SECTION
SCALE 1:20

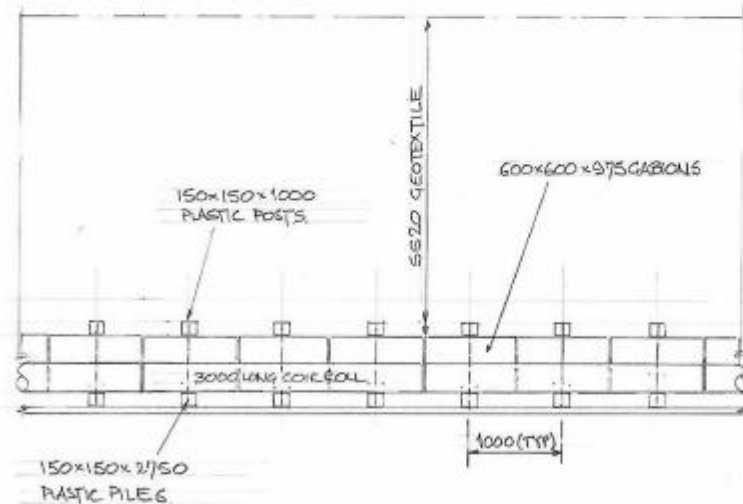

TYPICAL PLAN
SCALE 1:50

SCALES AS SHOWN AT A3.

WEY & ARUN CANAL TRUST
ROOKS HILL CANAL RESTORATION

GABION SOFT BANK DETAIL	04/10/25
DRAWING No RHC/212	REV A



Phase 2 Current status

- Planning permission issued Feb 2025
- Major excavation - material disposal on and off site
- Plastic wood donated by John Lewis
- Coir rolls and gabions needed
- Funding
- Start May/June 2026

Phase 2 Timetable 2026

- April/May. Stop planks installed at Birtley Bridge 1 and pump out. Tree stumps removed
- May/June. Construct link to existing canal
- June. Top soil strip of first section of east bank. Excavation to gabion level and start bank construction

Phase 2 Timetable 2026

- July. 2 weeks WRG summer camps
- August - October. East bank construction
- July - October. Muck shift and bank construction.

Phase 3 - 2027 +

- Fanesbridge Lock - planning permission granted
- Tree work completed
- Phase 1 Waterway wall work extended to lock in 2026?
- Start lock in 2027?

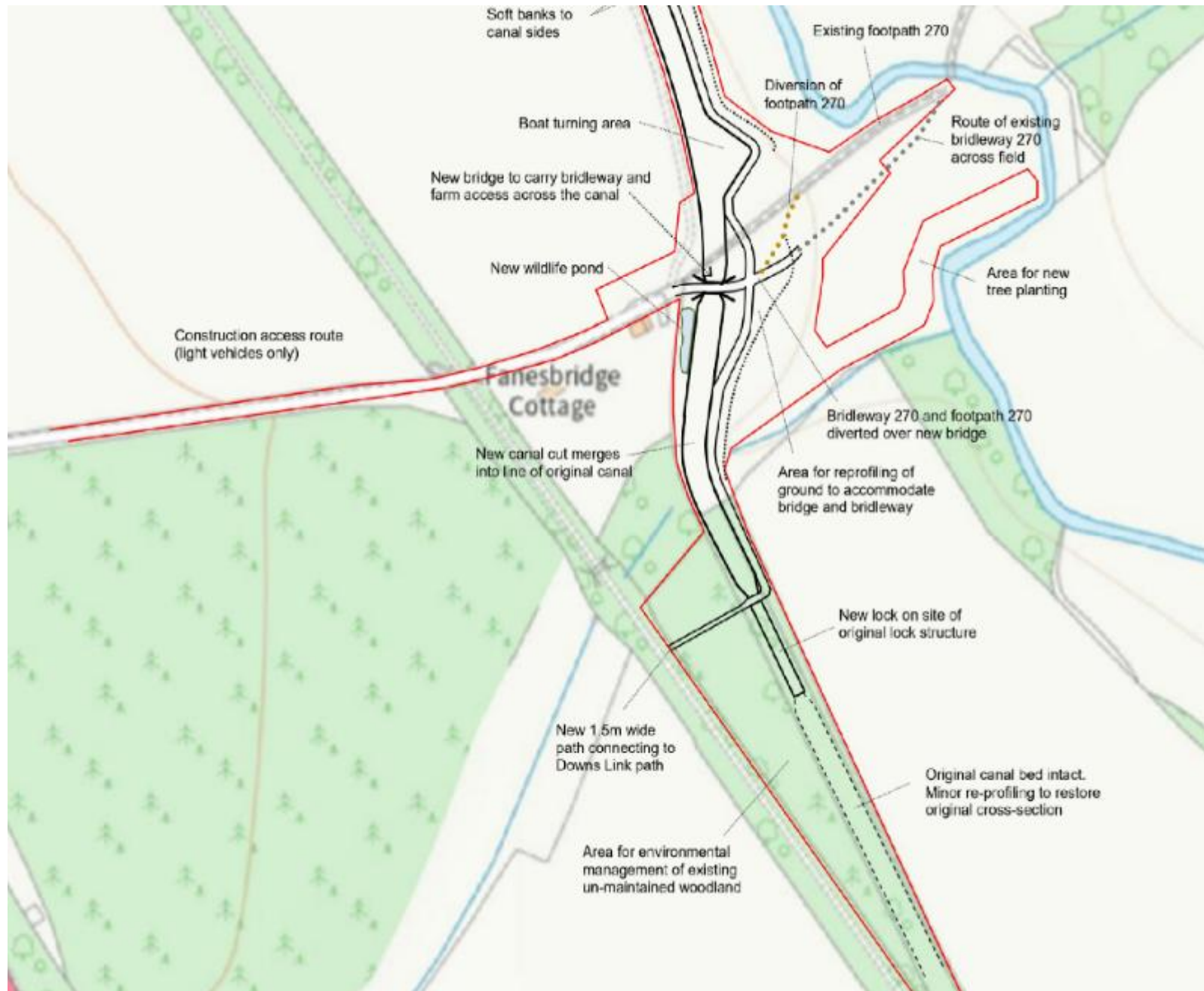





The End

WEY & ARUN
Canal
Trust